

AVENUE CROSS SECTION AND FLOOR PLAN

DESCRIPTION OF THE INTERVENTION

The main remodelling works are: moving the bike lane into the centre of the avenue, with the integration of new large-scale pedestrian crossings; the creation of new squares as receptacles for activities where the avenue meets the Eixample urban grid; the paving of intersections with the streets of Poble Sec, and the installation of new multifunctional columns. Shifting the bike lane into the middle of the avenue divides the width of the roadway, minimises the impact of the vehicle traffic and improves the feeling of proximity between the two pavements. It is delimited by lengthwise parterres filled with plants and caoutchouc protection elements, whose asymmetrical triangle-shaped design acts as an edge on the vehicle side and as an inclined plane flush with the paving on the bicycle side. On the pedestrian crossings, this central area is paved with granite, as a protective area in the middle of the avenue.

Where the north pavement of Paral·lel Avenue meets the streets of Eixample, each of the six new squares shape a unique space that integrates the road network -reduced to six-metres width- and three areas for pedestrians. Granite paving with continuous joints between areas and pedestrian crossings running the entire length of the squares, let the unique personality of the space be appreciated. This unitary nature is strengthened by a network of light points. The Paral·lel column was designed as a multifunctional medium capable of bringing together in a single article, with utmost flexibility and versatility, LED lighting both functional and decorative, communication elements, cameras and sensors.

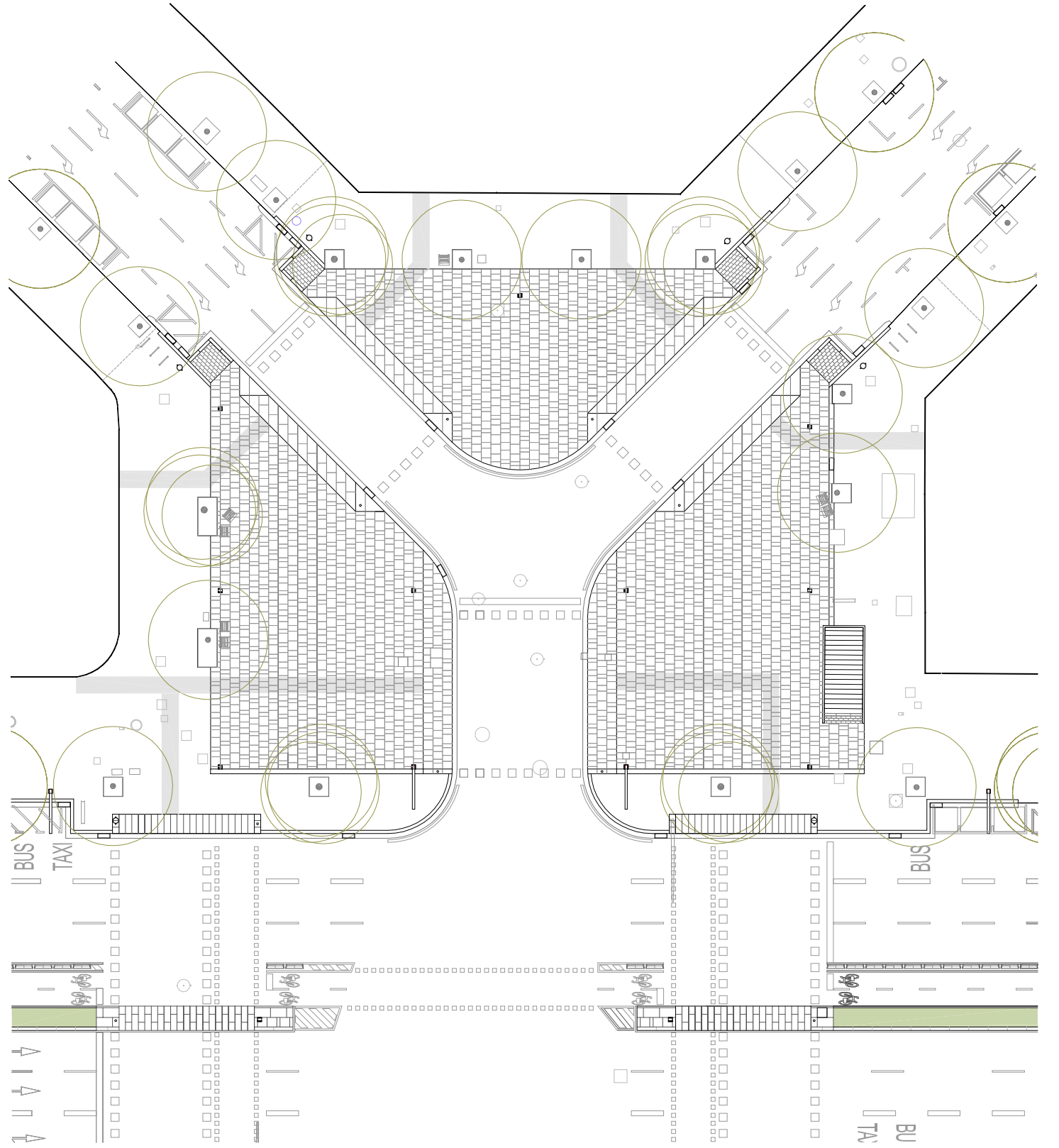

SQUARE FLOOR PLAN