

## J224- Urban park 'De Porre', Gent, Belgium

Conversion of an old factory to city park

The project aims to reconvert the old textile factory into a city park. This reconversion is part of a **mixed-use development urban renewal project**. In addition to the city park, two other building projects are realised: an extension of the sports school and the conversion of the warehouse into a Community Centre. The south-eastern part of the site (Peter Benoitlaan) will be developed into a housing project with some 60 new homes and lofts in the near future.

Surrounded, as it is, by a variety of functions and users, the park is under a lot of outside pressure. The aim was to create a diversified park which could cope with this pressure and stimulate a **renewed community life** for the neighbourhood.

The design brief proved a simultaneous exercise in creating a site with **plenty of flow**, while preserving walls and constructions and maintaining a logical, **workable zoning** of the park's functions.

Several **public participation sessions** were held with local residents during the design process, bringing additional ideas for the park programme to the table.

By preserving some historical artefacts, the park becomes an **'architectural landscape'**. On another level, the integration of portraits of former employees in the factory (central gangway), adds a **social dimension** to the historical one already present in the park's design.

On the whole, new meaning and new life are achieved by the bringing together of past and present. The walls and structures become the historical placemat for the development of new activities.

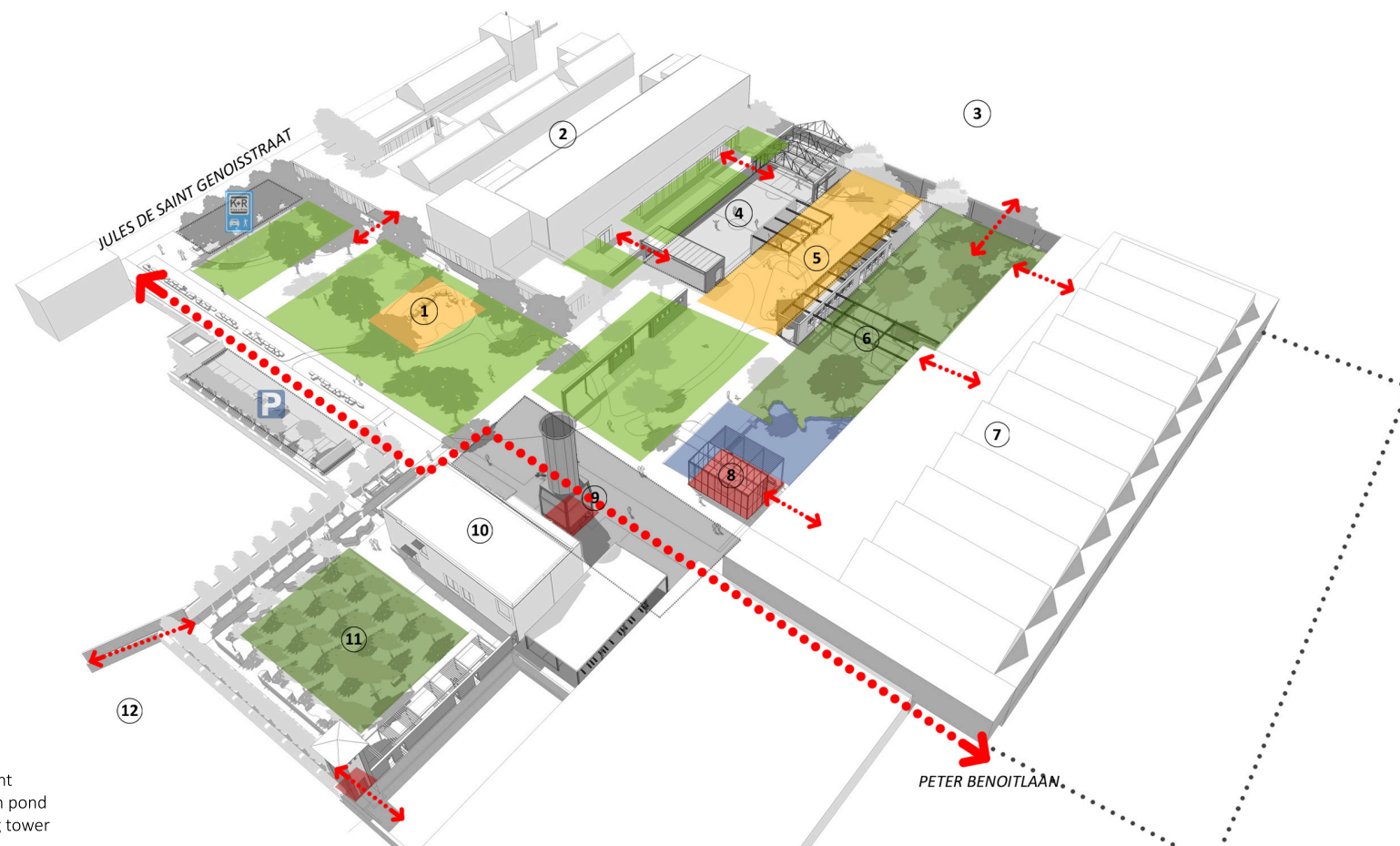

### LEGENDE:

1. play area children 0-5jaar
2. sports school
3. St. Gregorius school
4. multisports terrain
5. adventure playground
6. nature garden with wadi
7. future housing development
8. steam turbine pavilion with pond
9. central square with cooling tower
10. Communiy Centre
11. quiet orchard
12. Ter Heide garden district

### FUNCTIONAL ZONING PARK

