

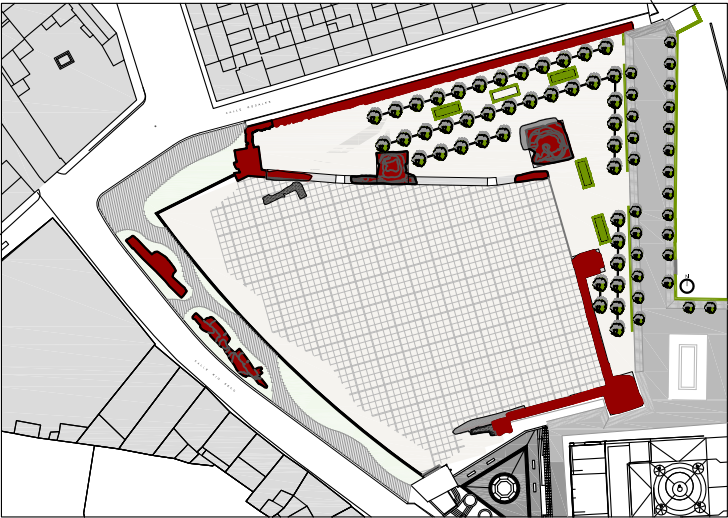

The field on which the action takes place inside enclosure comprises defensive fortress, clearly delimited and defensive towers fence inside the walls, all of which have been recovered in recent interventions by the municipality becoming legible shaping enclosure defensive. The Almohad Arab character of the place will be decisive when it comes to present a proposal in terms of form and content.

At around the same actions have been carried removal of buildings attached to the walls that prevented the display of these and readability of the defensive set and different restoration of paintings from the wall and urbanization of the surrounding spaces with them, what which currently allows for a well-defined and well-integrated into the urban fabric clearly identifiable enclosure.

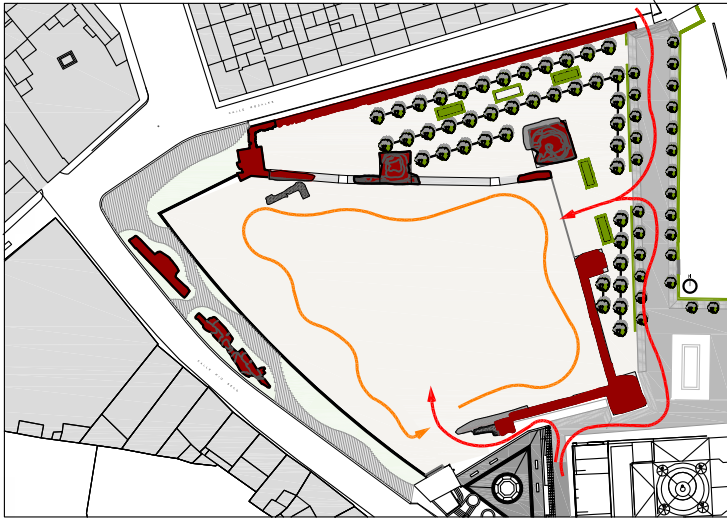

The space has two entrances, one from the southwest corner from Río Seco street from the triangular square next to Asunción church and the other inside the monuments through the projected between Portocarrero Palace pedestrian street, Mesa San Pedro and the parish of the Assumption.

It aims to create a hard area in the center, and a softer area next to the walls, with scattered trees to provide some shadow, creating a promenade where it could incorporate an inn interpretation outdoors on Al-Andalus (panels explanatory on the walls, defenses, fortress, fruit trees, gardens, mosaics ...) to complement the Orange Museum, located outside the citadel. This soft zone selected executed gravel allows the possibility of being well paved area occupied during events.

The basic idea provides that the central intervention paved area that is lost, causing a degraded, like the pavement of an excavation, damaged and lacking in some parts, especially at the edges. Thus the boundary between the harder and softer, executed with gravel area is diluted. This will be the closest to the wall and defensive towers area.



The proposal guarantees the respect and protection of architectural and archaeological emerging or underlying elements to which you have as a general rule avoid any excavation under the natural ground level, considering the various elements that make up the complex elements as overlapping the field existing and also with the possibility to withdraw if deemed necessary or appropriate for research activities or archaeological intervention in the case of this way of a perfectly reversible action and does not affect the underlying remains, whether known or not.

Precast concrete 1,5x1,5m are arranged in a grid of 6x6m, referring to the dimensions of orange groves, in line with the Orange Museum is expected, with a separation which allows easier expansion and which incorporates elements from these grids of 4x4 parts like water lines (channels) or linear lights in soils. To facilitate the redesign of these tiles traces of the figure above they are arranged.