

# 03 PLAÇA DEL RIU SEC I PASSAREL·LA DE LA FARIGOLA

Montserrat Periel, architect AMB

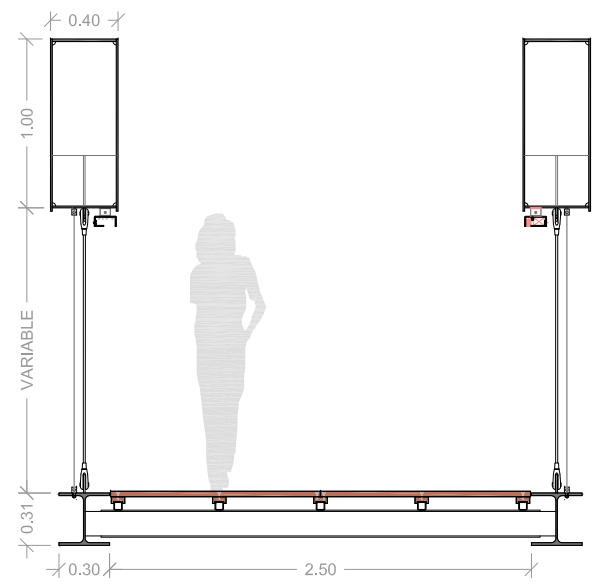

A\_cross section - Footbridge detail

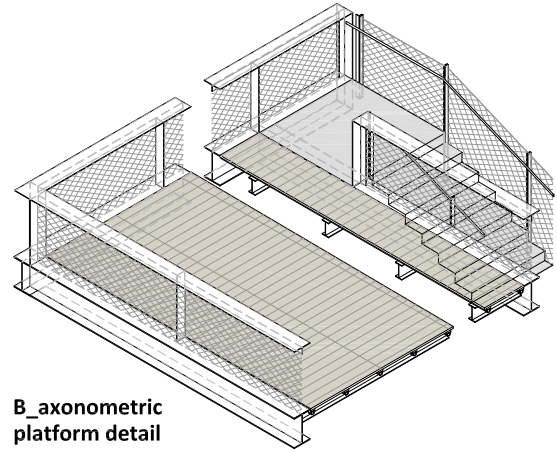

B\_axonometric platform detail

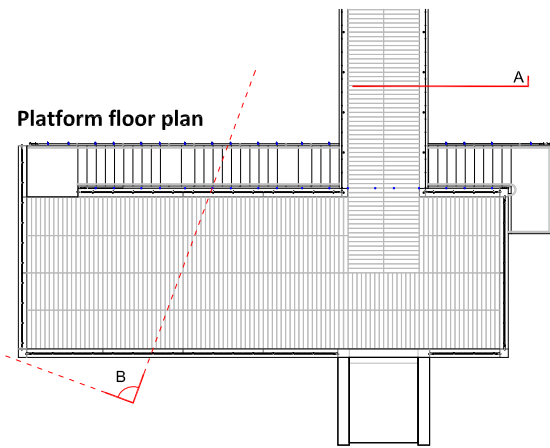

Platform floor plan



footbridge path

footbridge over railways and platform



access to footbridge from Barcelona Road



Riu Sec square and Farigola footbridge

footbridge and Frederic Puig Street

## EVALUATION OF THE RESULT

The new Riu Sec Square and the Farigola Footbridge represent the first step in the humanization of this environment that has had a devastating aspect for decades.

Consequently, the new topography introduced by the project, the clarity of the square and the design of the footbridge, as well as the choice of materials and construction techniques used, come from taking into account the nature of the environment and the balance between the strength of the intervention, which allows to organize the space, and the human scale that is transmitted by the adjustment in the sizing and the design of the elements, the used materials and the accurate details.

With this approach, the three strips of dark pavement that cover the square contrast with the interstitial areas of sand and grass that give the humanized and peaceful character required by such kind of garden-square.

With the increasing gradients of the square, the urban space runs away from the boundary of the confined contaminated subsoil, which increases the thickness of the protective earths and allows a free planting of large trees.

We will still have to wait for the construction of all the provided facilities so that the square and the footbridge can show all its fullness.

