

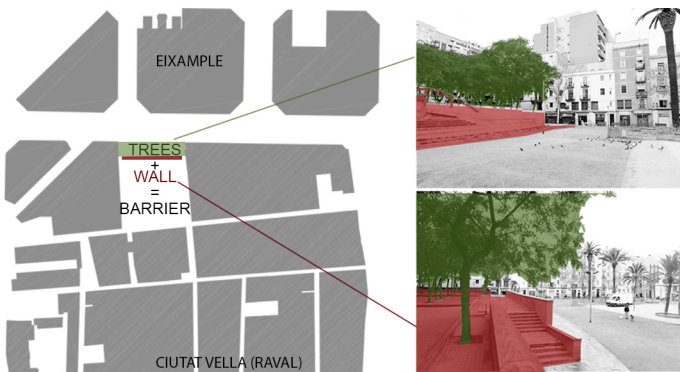

PICTURES BEFORE INTERVENTION

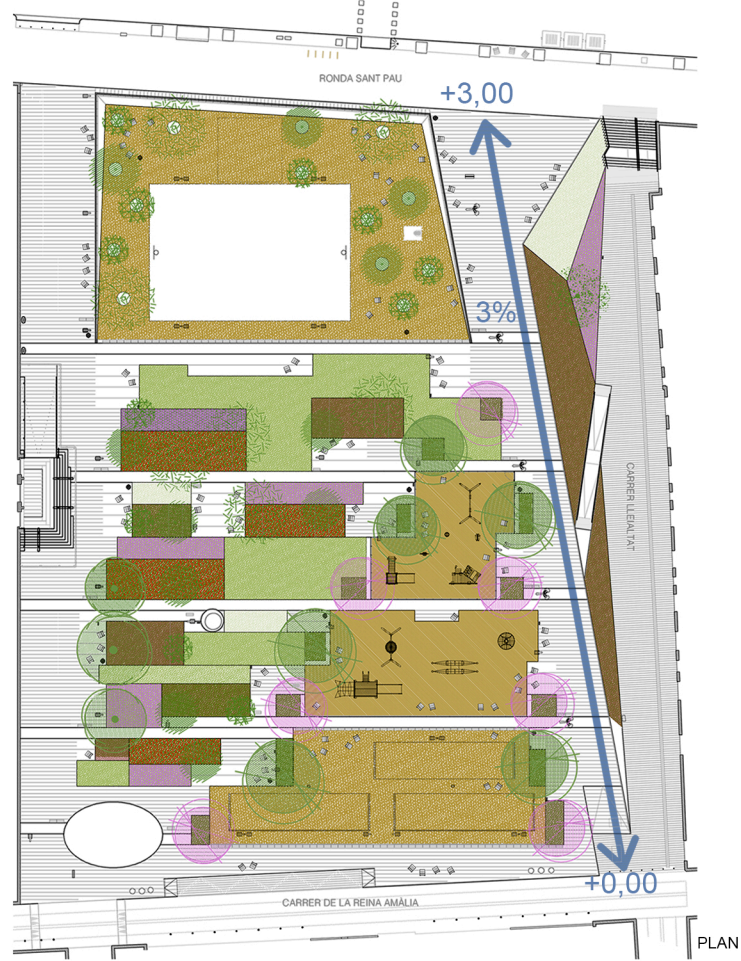

SECTION ( BEFORE AND AFTER)



## PLAÇA FOLCH I TORRES , BARCELONA

FROM CUL-DE-SAC TO GATEWAY  
JORDI FARRANDO

### Before intervention

Ciutat Vella and Eixample are two districts of Barcelona that are significantly different, not only in terms of their urban morphology but also because of their social composition, their commercial activity or the role they play in the city as a whole. Within Ciutat Vella, Raval is, moreover, the neighborhood with the highest percentage of population at risk of exclusion and the highest number of problems of coexistence among groups. It is, therefore, where public space has a more significant role in the articulation of coexistence.

The Folch i Torres square is located on the edge of the Raval, just next to the Eixample, of which it is separated by the Ronda de Sant Pau, halfway between two worlds that are substantially different.

Located in a lot where the women's prison of Barcelona was located until 1936, it was the object of a redevelopment at the end of the 1980s. This led to the creation of a large sandy area, located at the level of the Reina Amàlia street, and a paved terrace with a dense robinia plantation, at the level of the Ronda de Sant Pau, about 3m above the previous one. The difference between the two levels was saved by a wall that included an ornamental fountain.

This organization of the space, quite logical at first glance, had been transformed over the years into an accumulation of elements where uses were being located based on opportunity rather than on organizational coherence, so that the basketball court ended literally next to the children playground, or the petanque court right at the opposite end of the center for elderly people.

It had also become a segregated space, which neighbors perceived as Raval's last frontier. Even if the Eixample is just across the street, the feeling was that it was extremely far away, "behind" the wall with the fountain and the wooded mass. To reach it, it was necessary to take the stairs of Lleialtat Street or a semi-hidden ramp on one of the sides. The feeling of being next to another world with which there was little opportunity for dialogue was increasingly intense.

