



BLUE HOUSE YARD

Blue House Yard is an urban intervention on a disused carpark that mends the broken city fabric at the backstreets of Wood Green, North London. A converted office building, a double decker bus cafe and 9 artisan worksheds provide the backdrop and the conditions for an accesible and lively public events programme, with the aim of establishing Blue House Yard as a destination for local people and visitors from further afield.

The timber-frame worksheds are largely built by volunteers and apprentices using simple construction methods and material by local suppliers. Blue House Yard is the start of a much wider cultural vision for the area that aims to outlive its five years life span by being a catalyst for change and setting the precedent for positive creative change elsewhere in the borough. The timber sheds are de-mountable and can be re-erected on another site once the town centre masterplan is eventually implemented.

Team: Jan Kattein Architects with Meanwhile Space CIC
Client: London Borough of Harringey

PHOTO (TOP LEFT): INITIAL SKETCHED PROPOSAL OF THE BLUE HOUSE YARD (BOTTOM LEFT): PHOTOGRAPH OF FINISHED SCHEME WITH FOOD MARKET. (MIDDLE LEFT): PHOTOGRAPH OF THE DISUSED CAR PARK BEFORE THE INTERVENTION.

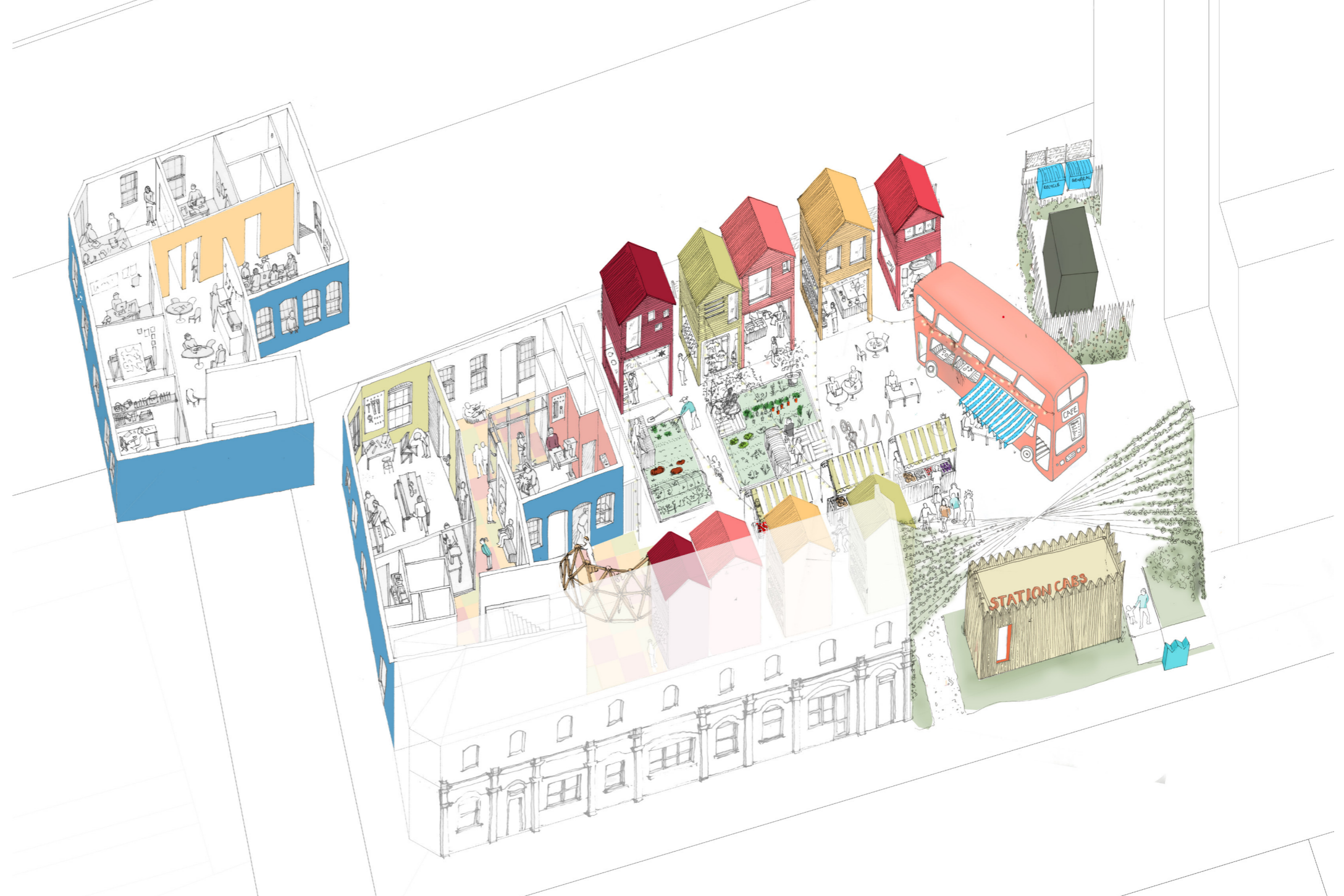

1:1250 LOCATION PLAN



JUNE 2016



JUNE 2017