

ZUIDBOULEVARD, WAREGEM

In the early 1970's, the historic city centre of Waregem was expanded with "Het Pand", a modernist ensemble containing a new city hall, police station, post office, cultural centre, shops and a multiplex theatre.

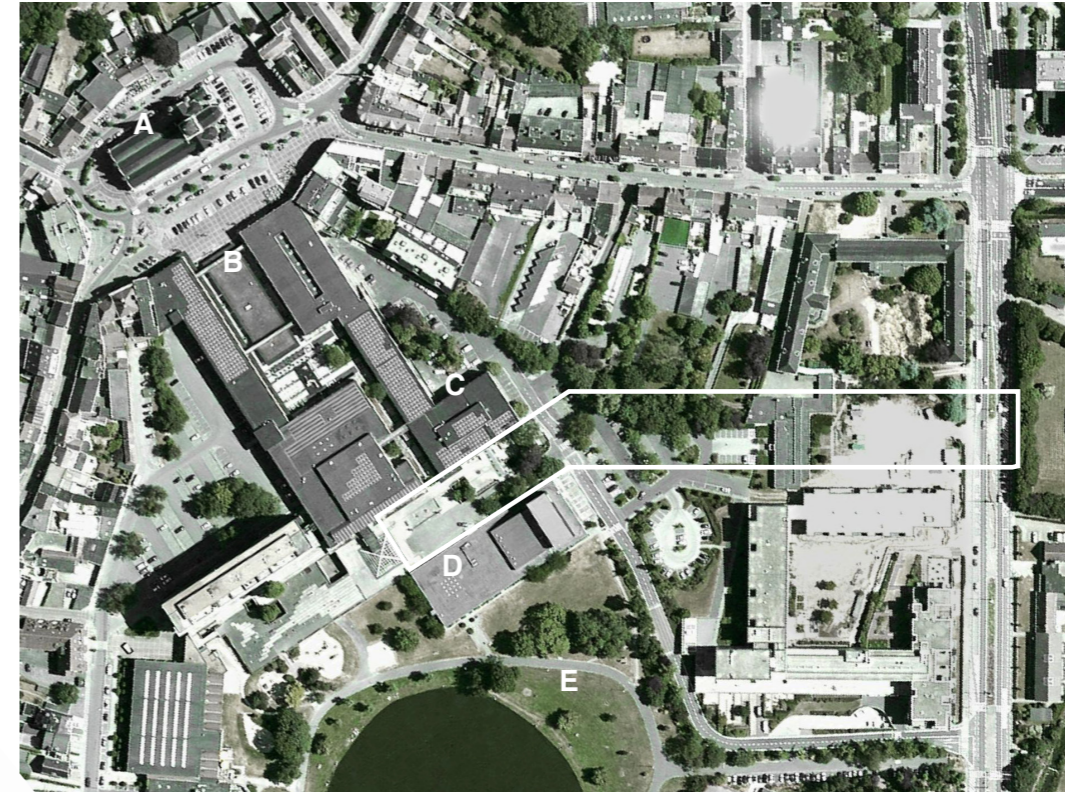
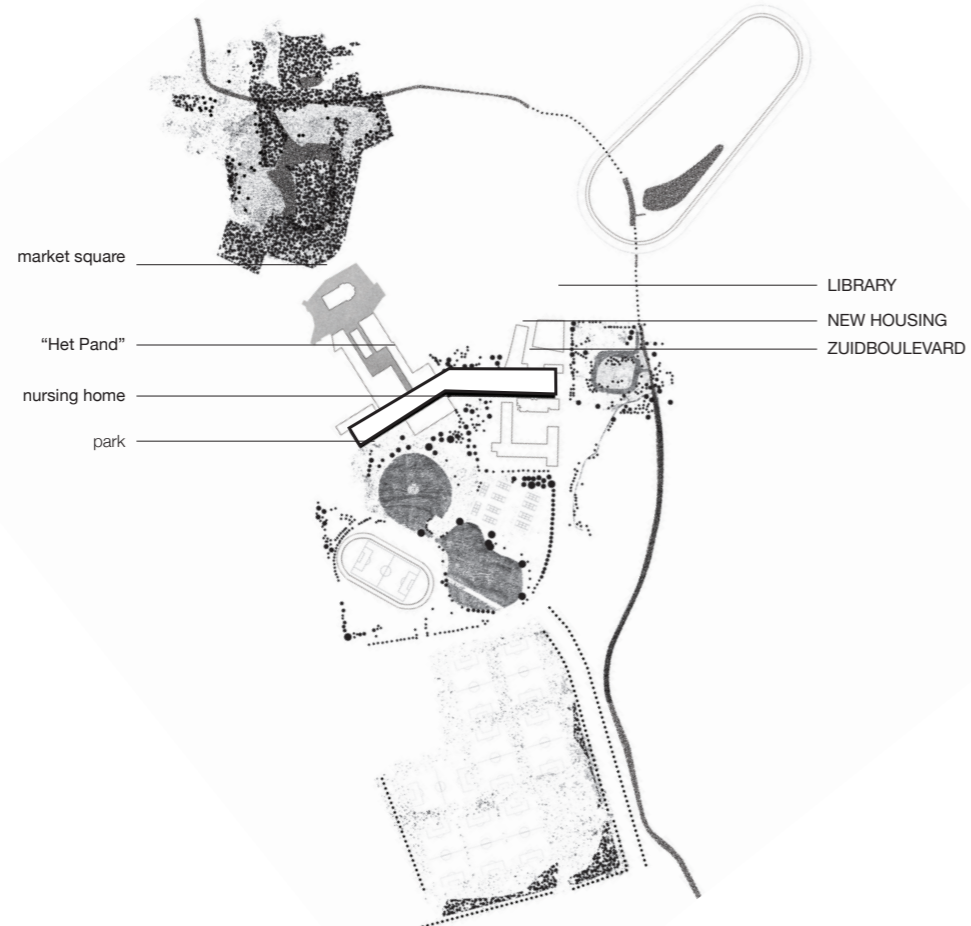

A. Church B. Shoppingcentre C. City hall D. Cultural centre E. Park

Forty years later, the project for the 'Zuidboulevard' completes this unfinished modernist project.

In true modernist tradition, pedestrian and motorized circulation within this complex was split over two levels. A pedestrian deck connects to the level of the market square to the immediate North. All shops and civic buildings have their main entrances on this level. The floor underneath is occupied by a large parking lot and technical spaces. Due to the natural slope of the terrain, this lower floor lays at the same level as the park situated to the South. Both levels are connected by a series of stairs and elevators. Trees, planted on the lower level, stick their crowns through openings in the upper deck.

Because of this spatial organization, the pedestrian deck is disconnected from the public domain located to the South and East. Prior to our intervention, the two were only connected by a single staircase and ramp.

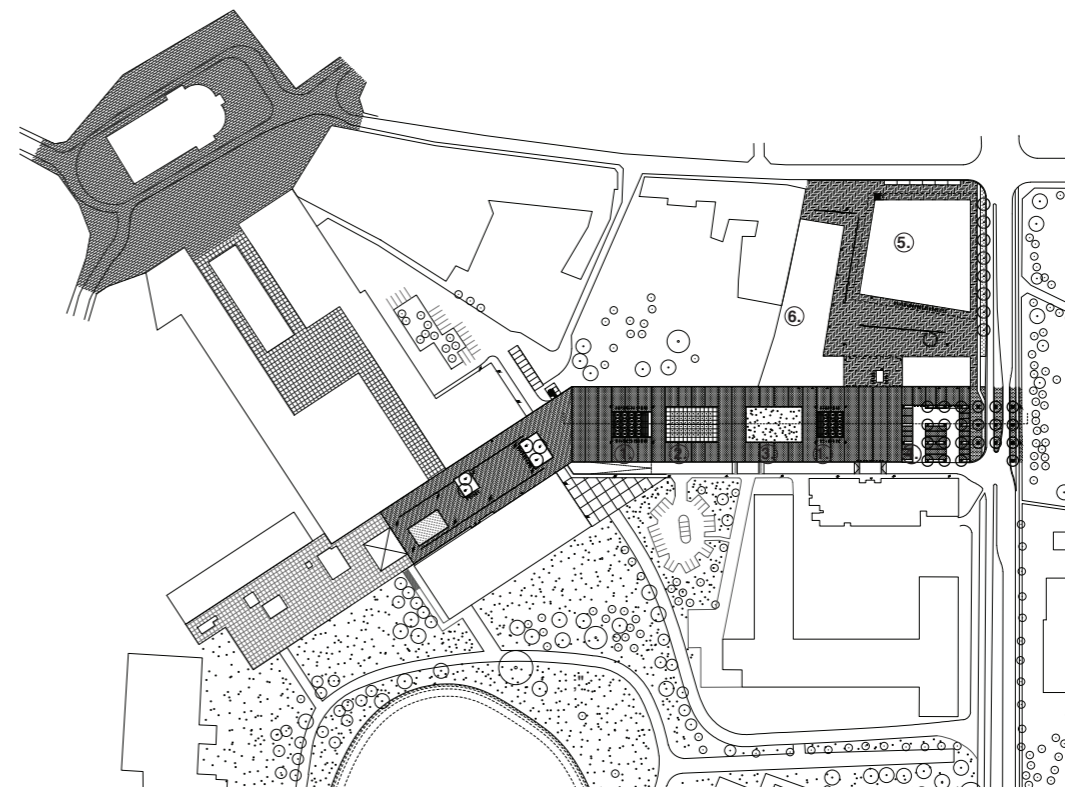

1. Staircase 2. Water feature 3. Lawn 4. Short term parking 5. Library 6. New housing