

PHASE 01 - JULY 2017

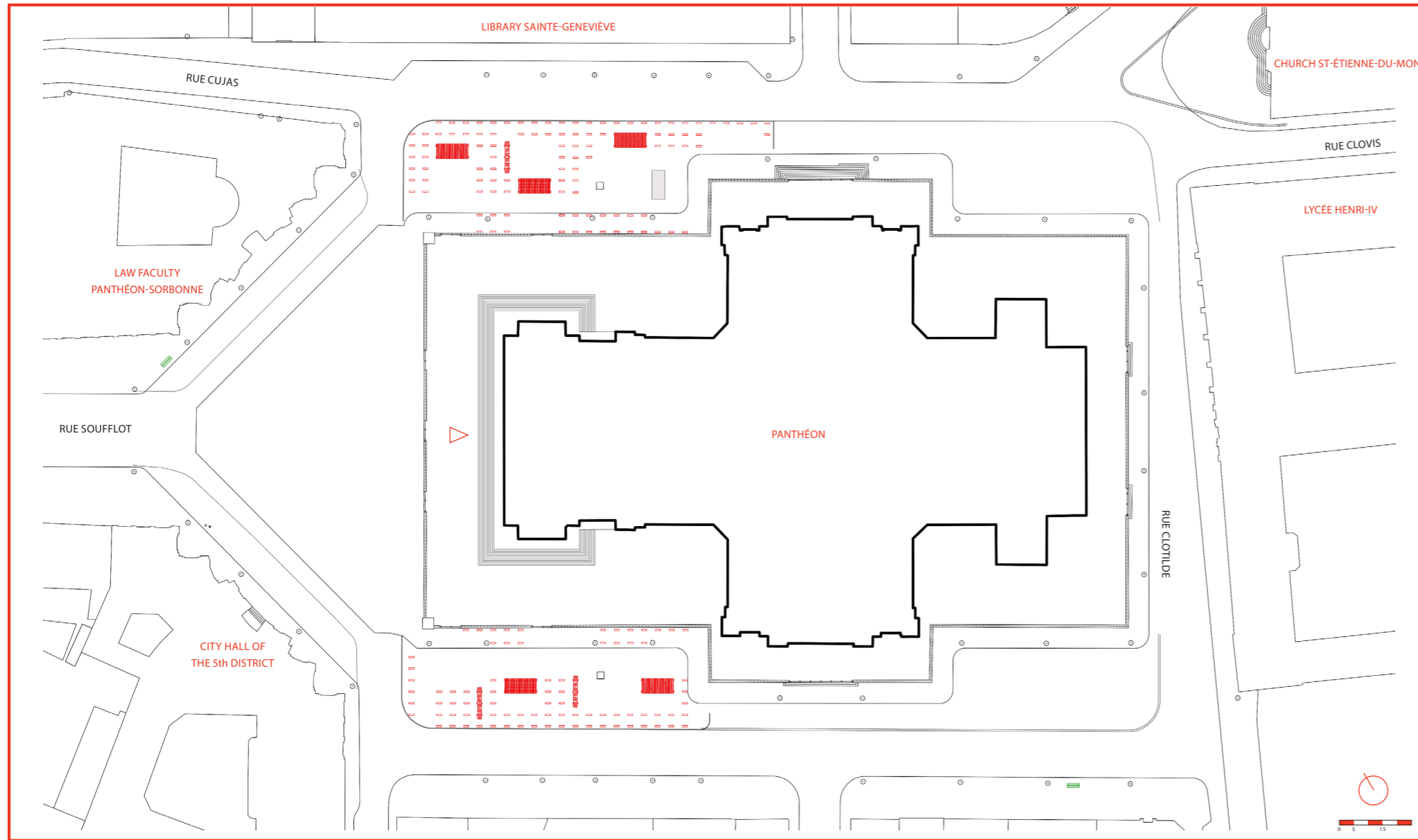

In terms of landscape and amenities, our project aims at respecting the original mineral design of the plaza, while reinventing it: hard granit stone pavement and engraved limestone facades. All materials to be exploited on site are taken from the city's recycling streams.

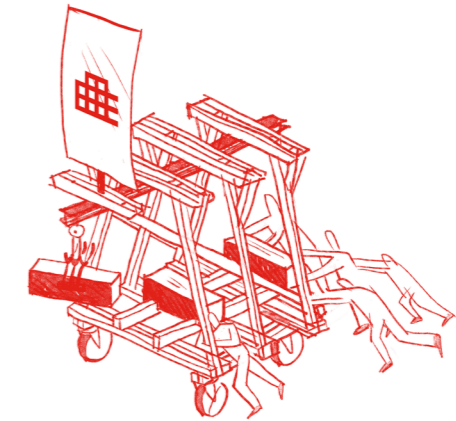

The two weeks long construction workshop, took place directly on site, making it accessible to the users to follow and discuss the daily evolution of the space. The construction time was punctuated by symbolic, educational and friendly events.



Last day of the two-weeks long construction workshop (july 2017)



Parallel to the construction, a symbolic event took place to highlight the place of women in society in general, and public space in particular. Only 4 women (out of 80 people) are buried in the «Great Men of the Nation» monument.

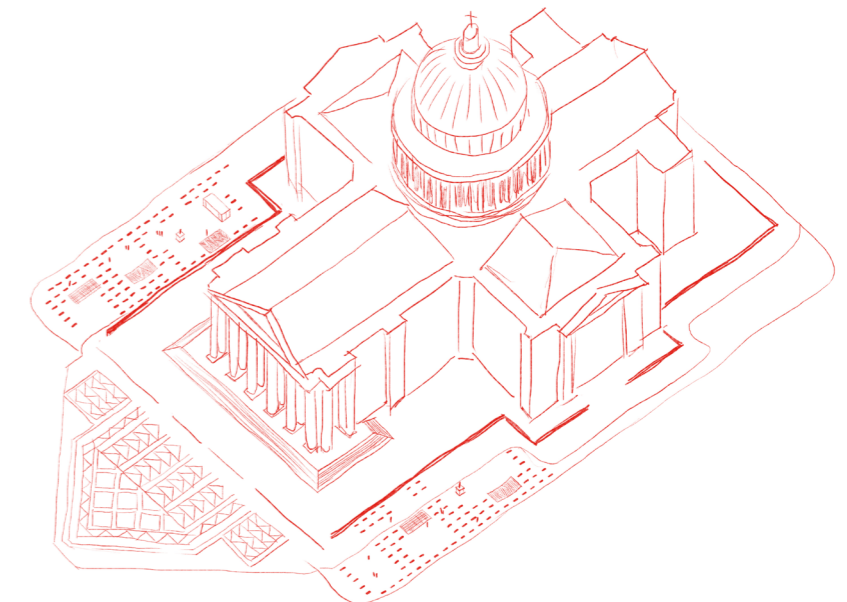

A frame of granite blocks was arranged, offering a visual unit. On some of these blocks, wooden elements were designed to suggest and experiment different uses and possibilities, before making the design permanent.