

PLAN 1:2000

FROM BACKSIDE TO URBAN LIFE

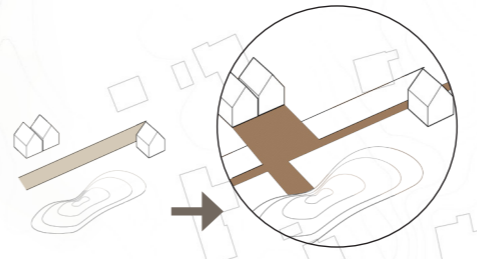

TOWN FLOOR CREATES COHERENCE

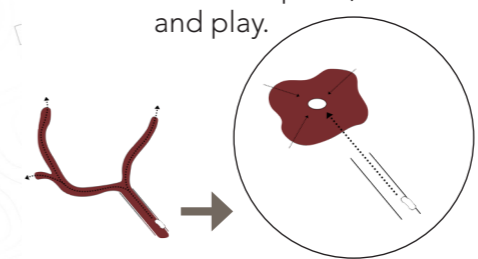

THE SQUARE IS A FRAME FOR URBAN LIFE

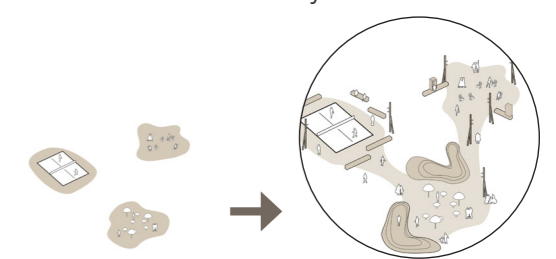

THE FURNITURE ESTABLISH A NEW URBAN SCENOGRAPHY

## A SITE-SPECIFIC POTENTIAL CREATED A NEW IDENTITY

The Wadden Sea was in 2014 classified as UNESCO World Heritage. The vision of this project was to re-establish Fanø Bad as a special spot in the Wadden Sea, by using the historic promenade culture as an inspiration for a modern vacation spot, while creating a better relationship between landscape and town. The project might have a small budget but it was a significant investment for Fanø Municipality, and the square is a part of a long-term development plan.

The few elements of the projects are all inspired by the history and nature at Fanø. The most important element is the new town floor consisting of a brick pavement, in a mix of yellow and grey bricks. The colour scheme is inspired by the nature on Fanø, when the tide is low, sand and water creates a special light, which the coal-burnt brick recreates when it reflects the sun. The lighting elements are reinterpretation of historic seamarks, and the large chandelier forms a new landmark and focal point, while the furniture creates room for stay and play.

